



# Service Tools New Product Releases

January 2015



# Mechanical Service Tools

ENGINE RANGE	PART NUMBER	DESCRIPTION	ENGINE FAMILY	ESTIMATED EFFECTIVE DATE	PRODUCT MANAGER	TOOL TYPE/SOURCE
MR	5299141	Protective Cover Kit	ISB5.9, ISL G, ISX12 G	Feb-2015	<a href="#">Tracy Coleman</a>	Required/ Cummins Only
MR	52299140	Protective Plug Component of 5299141		Feb-2015	<a href="#">Tracy Coleman</a>	
MR	4919788	Protective Plug Component of 5299141		Feb-2015	<a href="#">Tracy Coleman</a>	
MR	5298979	Overhead Setting Kit	Multiple	Feb-2015	<a href="#">Tracy Coleman</a>	Productivity/ Cummins or Equivalent
MR	3165143	Storage Case Component of 5298979		Feb-2015	<a href="#">Tracy Coleman</a>	
MR	4919692	Feeler Gauge Component of 5298979		Feb-2015	<a href="#">Tracy Coleman</a>	
MR	4919779	Feeler Gauge Component of 5298979		Feb-2015	<a href="#">Tracy Coleman</a>	
MR	5298983	Storage Case Component of 5298979		Feb-2015	<a href="#">Tracy Coleman</a>	
MR	5299371	Drive Adapter Component of 5298979		Feb-2015	<a href="#">Tracy Coleman</a>	
MR	5299372	Drive Handle Component of 5298979		Feb-2015	<a href="#">Tracy Coleman</a>	
MR	5299373	Drive Handle Component of 5298979		Feb-2015	<a href="#">Tracy Coleman</a>	
MR	5299516	Feeler Gauge Component of 5298979		Feb-2015	<a href="#">Tracy Coleman</a>	

# Mechanical Service Tools

ENGINE RAGE	PART NUMBER	DESCRIPTION	ENGINE FAMILY	ESTIMATED EFFECTIVE DATE	PRODUCT MANAGER	TOOL TYPE/SOURCE
HD	5299476	Crankshaft Seal Installer Kit	ISG & QSG	Feb-2015	<a href="#">Tracy Coleman</a>	Required/ Cummins Only
MR	5299128	Pressure Gauge Adapter	LDD	Feb-2015	<a href="#">Tracy Coleman</a>	Required/ Cummins Only
MR	5299499	Pressure Gauge Adapter	LDD	Feb-2015	<a href="#">Tracy Coleman</a>	
HD	5299448	APR Liner Tool Kit	ISX15	Feb-2015	<a href="#">Tracy Coleman</a>	Required/ Cummins Only
HD	5299447	Insert Remover Component of 5299448		Feb-2015	<a href="#">Tracy Coleman</a>	
HHP	5299335	Service Tool Replacer	K19, K38, K50	Feb-2015	<a href="#">Tracy Coleman</a>	Required/ Cummins Only
HD	5299624	Leak Test Hose	ISG & QSG	Feb-2015	<a href="#">Tracy Coleman</a>	Required/ Cummins Only

[Back](#)

[Next](#)

# News and Contact Information

- [Who We Are](#)
- [New Service Tools Coming Soon \(scheduled available February 2015\)](#)
- [Obsolete Tools](#)

Click on the title to view the News Story.

[Back](#)

# Who We Are

- Cummins Service Products offer a broad array of durable service tools and consumable items to help you maintain the high level of quality and service your customers expect and deserve. These products, designed and manufactured to meet Cummins exacting standards, guarantee quality and performance and are backed by professional support, competitive pricing and worldwide distribution.
- Additional Cummins [Service Products](#) information can be found on QuickServe Online (QSOL) under the Products Tab. Information available includes:
  - A complete catalog of all service tools offered by Service Products
  - Wiring Repair Kit Content Sheets for Wiring Repair Kits, Clean Care Protective Cover Kits and Certification Kits
  - Electrical Connector Database – **more details are available in the “New Electrical Connector Database” article**
- We welcome any feedback/content ideas for the Service Products News. Please feel free to e-mail Tracy Coleman, Commercial Product Manager at [tracy.coleman@cummins.com](mailto:tracy.coleman@cummins.com)

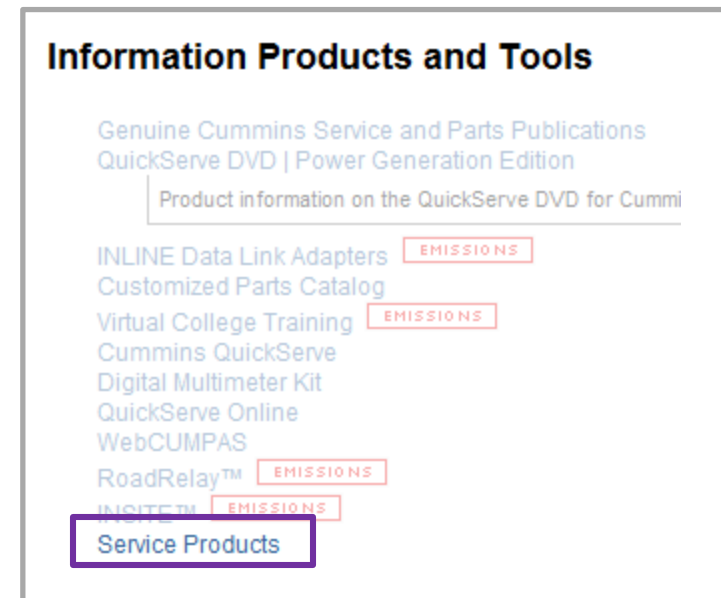

# 5299141 – Spark Plug Clean Care Kit

This kit is used to plug the spark plug cavities of the following series of Cummins Westport natural gas engines with the spark plugs removed.

## 3400478 Tool Information Bulletin

- ISX12 G CM2180 EJ = Plug P/N 4919419
- ISL G CM2180 = Plug P/N 5299140
- ISB5.9 G CM2180 = Plug P/N 4919788

Due to become available February 2015

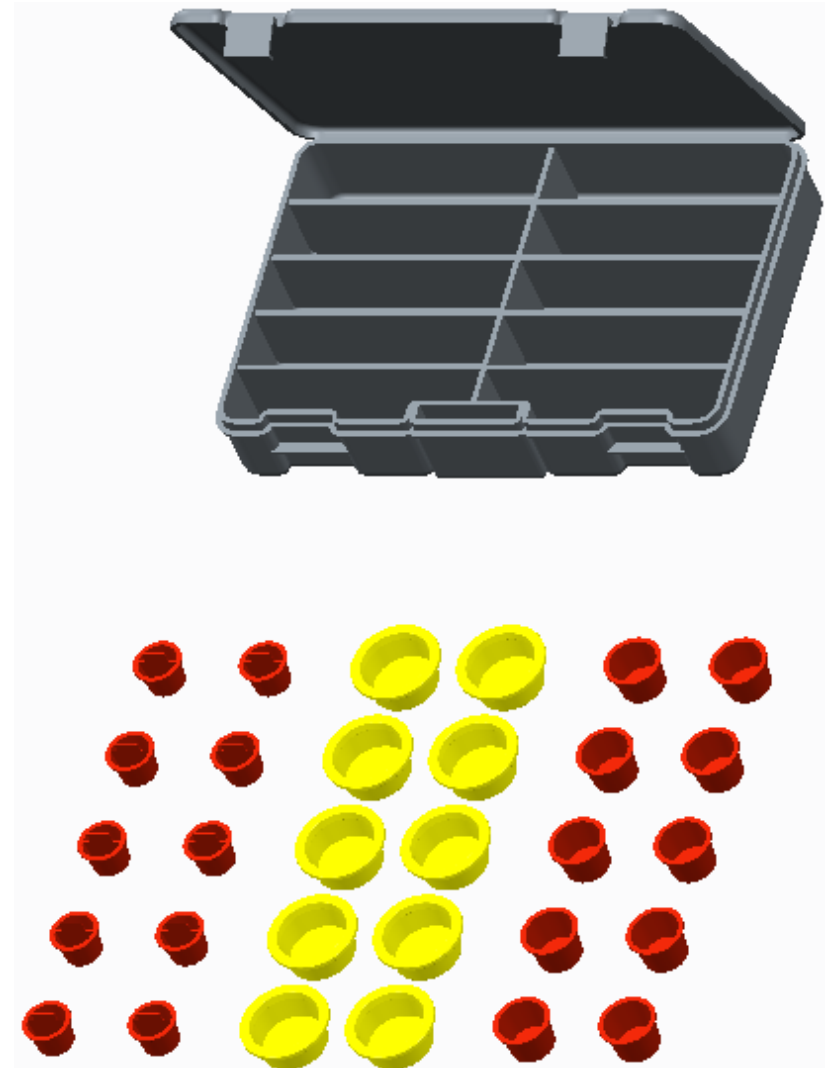

# 5298979 – MR & HD Overhead Setting Kit

This master overhead setting kit is used to set the overhead (including engine brakes) on modern electronic (IS\_ & QS\_) MR & HD engines.

- (B4.5, B6.7, C8.3, L9 diesel, L9 gas, M11, X12 diesel, X12 gas, Z13, G11, G12, X15).
- Includes new p/n 5299516 0.036" feeler gage for setting ISX12 G exhaust valve lash.
- All tools available individually.
- This kit obsoletes and supersedes the following kits: 3163167, 3163196 & 4919363.



Due to become available February 2015.

# 5299476 – Crankshaft Rear Seal Installation Kit

This kit is used to install the crankshaft rear seal to the proper depth on ISG & QSG series engines with or without a REPTO option.

Due to become available February 2015.

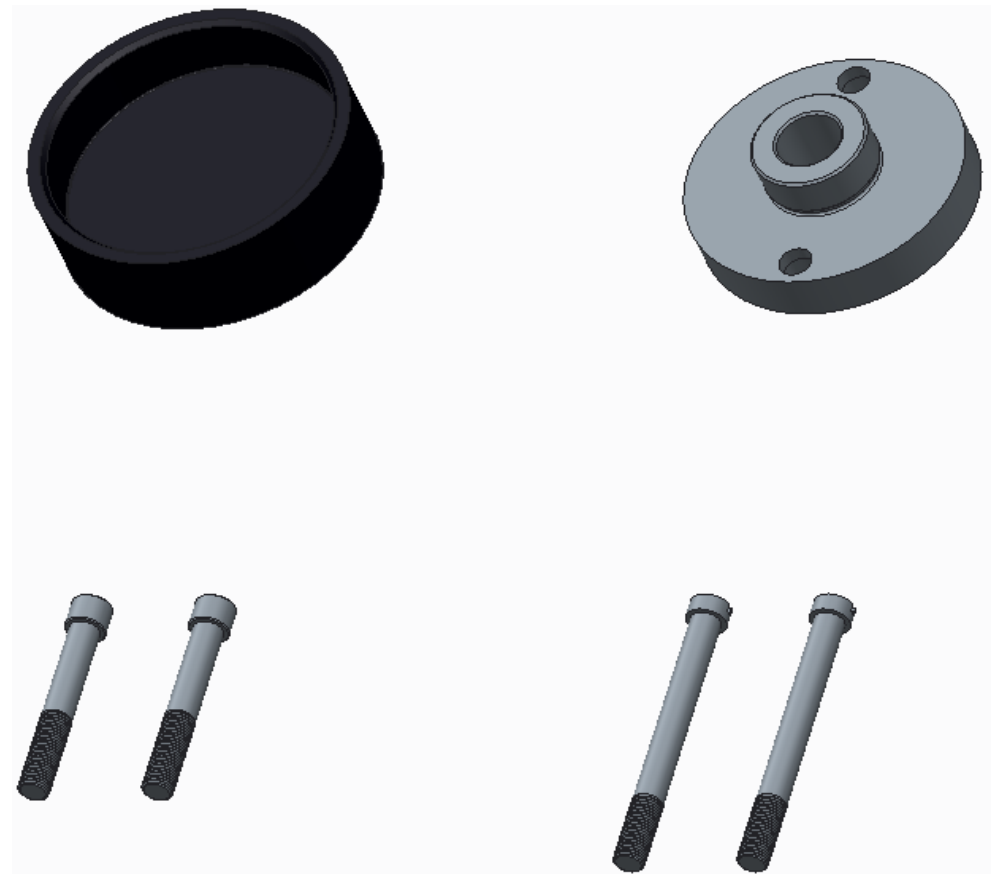



## 5299128 – Fuel System Pressure Test Kit



This hose assembly is used to check the fuel inlet restriction and the drain line pressure on engines equipped with a **12.61 mm** quick disconnect fuel line fitting.

Used on ISV series engines.

Due to become available February 2015.

## 5299499 – Fuel System Pressure Test Kit



This hose assembly is used to check the fuel inlet restriction and the drain line pressure on engines equipped with a **9.89 mm** quick disconnect fuel line fitting.

Used on ISV series engines.

Due to become available February 2015.

## 5299448 – APR Liner Tool Kit



This kit is used to remove anti-polishing rings (APR) and allow installation of pistons into 15L engines that have been produced or upfit with APR liners. APR liners were introduced in January 2015.

Due to become available February 2015.

# 5299335 – Coolant Manifold Tube Removal & Installation Tool

This tool is used to install or remove the water transfer tubes from the rocker lever housings.

Used on K19, K38, K50 series engines.

Obsoletes & supersedes tool ST-1319.

Due to become available February 2015



## 5299624 – Hose Assembly

Hose assembly consisting of a 0.25" ID, 0.375" OD, 1830 mm long, yellow tinted, fuel compatible hose and a 45 degree SAE / 37 degree JIC female - 4 (7/16 – 20) swivel 90 degree fitting.

Can be used for any low pressure fuel drain checking procedure where p/n 3164673 (same but with straight fitting) is specified but cannot be used due to access restrictions.

Due to become available February 2015



# The Following Tools Have Been Obsoleted Without Supersession

Kit P/N	Name	Description
ST-892	Fan Hub Wrench	This special thin head design fan hub wrench is used to tighten and/or loosen the large fan hub locknut on C & J series engines with 1 11/16 in hub nut.
3376465	Valve Guide Reamer	This reamer is used to ream the ID of valve guides as required to assure that the valves will have proper clearance. Used on J (2 valve head), NH, V12 4 7/8 & 5 1/8 bore series engines.
3823568	O-Ring	Serviceable part of obsolete camshaft bushing removal & installation kit 3823509
3823586	O-Ring	Serviceable part of obsolete camshaft bushing removal & installation kit 3823509
3164697	Spacer	Serviceable part of obsolete engine lifting fixture update kit 3164514
3164698	Spacer	Serviceable part of obsolete engine lifting fixture update kit 3164514
3164699	Spacer	Serviceable part of obsolete engine lifting fixture update kit 3164514
3164700	Spacer	Serviceable part of obsolete engine lifting fixture update kit 3164514
3164740	Spacer	Serviceable part of obsolete engine lifting fixture update kit 3164514
3164981	Diesel Fuel Additive	16 oz container of diesel fuel additive. Treats up to 45 gallons of diesel fuel
3164982	Diesel Fuel Additive	32 oz container of diesel fuel additive. Treats up to 250 gallons of diesel fuel
ST-1166	Magnetic Crack Detection Kit	This tool is used to inspect cylinder heads or blocks for cracks that cannot be magnafluxed easily for cracks, especially in the area of the valve seat, injector bore area and/or counterbores. Kit contains a two prong magnet and a graphite powder distribution bulb.
ST-1166-7	Powder Applicator	Used to apply the crack detection powder to surfaces to be tested. Included in kit p/n ST-1166.
ST-1166-8	Crack Detection Powder	Used to identify cracks in ferrous metals. Included in kit p/n ST-1166.
ST-1252	Concentricity Gage	This gage is used to check the alignment concentricity between the cylinder liner upper counterbore and the lower packing ring bore.
ST-1252-1	Dial Indicator (SAE)	Included in ST-1252.
ST-1252-2	Cylinder Block Counterbore Contact Plate	Included in ST-1252.
3823572	Cylinder Block Counterbore Contact Plate	Used on K19, K38, K50 engines. Used with ST-1252.

Stock of these tools at global PDCs will be sold until exhausted.

# Opening All Product Releases

To download an Excel spreadsheet containing all the product releases, click on the paper clip icon and then double click on the Excel document within the left hand Attachments menu inside Adobe Reader.

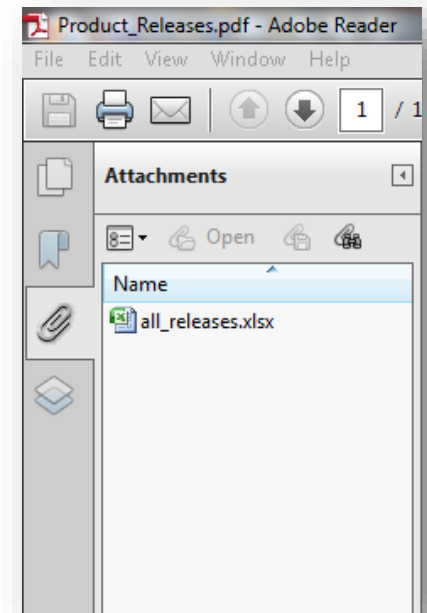

If you receive this dialog box, be sure the radio button is next to “Open this file” and then click OK.

